

# Plat of Survey

of

## Lot 45 of Ross D. Sill's Subdivision of Large Lots I and II, Camp Sybil,

a subdivision located in the Northeast 1/4 of Section 18, Town 1 North,  
Range 17 East, Town of Linn, Walworth County, Wisconsin.

Surveyed for: **Glenn Morgenroth**  
18N101 Hidden Hills Trail  
West Dundee, Illinois. 60118

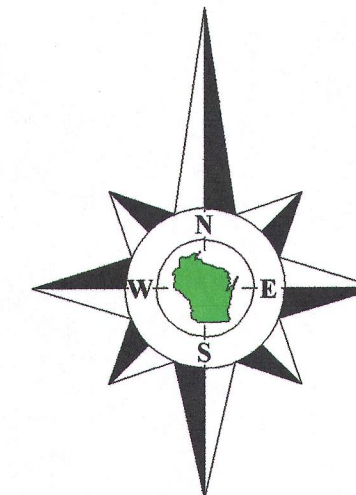

Bearings reference to the Wisconsin State  
Plane Coordinate System, South Zone.

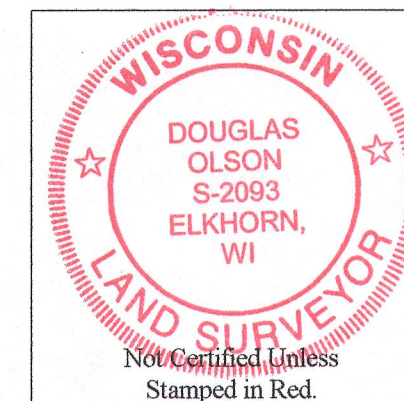

### Notes:

- 1) This survey plat is not certified unless signed and sealed in red ink.
- 2) This survey is subject to Wisconsin lien laws. This Plat of Survey is the notice of intent to file lien. Lien waiver required.

Copyright 2012 by Jensen & Olson Land Surveying, LLC.

All rights reserved. No part of this survey plat may be reproduced or transmitted in any form by any means - graphic, electronic, or mechanical, including photocopying, tracing, or information storage and retrieval systems - without permission in writing from Douglas G. Olson, Jensen & Olson Land Surveying, LLC.

I, Douglas G. Olson, Wisconsin Registered Land Surveyor, do hereby certify that this survey was performed by me, or under my direction in full compliance with the owner's/agent's instructions and Chapter A-E 7 of the Wisconsin Administrative Code "Minimum Standards for Property Surveys", and that this map is an accurate representation thereof to the best of my knowledge and belief.

Douglas G. Olson  
Wisconsin Registered Land Surveyor - 2093

South 1/8 Corner of  
the Northeast 1/4 of  
Section 18-1-17.

East 1/4 Corner  
Section 18-1-17.  
N. 202,349.48  
E. 2,398,457.54

N89°30'42"E 2636.77'  
(N89°30'42"E 2636.77') State Plane

N89°23'02"E 803.62'

N89°23'02"E 1316.33'

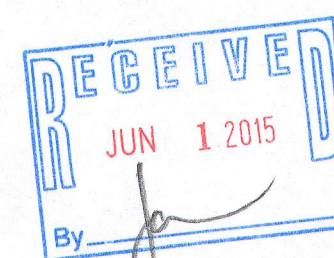

Center 1/4 Corner  
Section 18-1-17.  
N. 202,327.01  
E. 2,395,820.88

Sybil Lane  
(15' Wide)

N1°54'39"W 49.99'

**Lot 45  
Tax Parcel  
ICA 00043**

0.069 Acre  
2,995 Sq.Ft.

Deck

**Poured  
Concrete  
Foundation**  
Located 01-07-13

**House  
N1522**

Gas  
Meter

Lot 44

Lot 48

Tax Parcel  
IL 1800007

Survey Date: Sept. 14, 2012.  
Revisions: No. 1 - Proposed Addn.  
No. 2 - Addition @ 8' from  
Property line  
No. 3 - Foundation  
No. 4 - Lot number typo

Scale in Feet  
1" = 10'  
0' 5' 10' 20'

**Jensen & Olson Land Surveying, LLC**

45 South Wisconsin Street \* P.O. Box 322 \* Elkhorn, Wisconsin. 53121  
Telephone: (262) 723-3434 \* Facsimile: (262) 723-8044  
Email: jensen.olson@elknet.net

**Legend**  
Found County Section Corner  
Found Iron Pipe, 1" dia.  
Set Iron Pipe, 1" dia.  
Recorded Information  
Utility Pole  
Concrete Cover  
Asphalt Surface  
Gravel Surface  
Brick Pavers

Sheet 1 of 1 Sheets

Job Reference Number

2012.104

2012.104

ICA - 43 117-3792